

ANTARCTICA Aquatic Nature®

EN INSTRUCTIONS

INSTALLATION of the RO unit

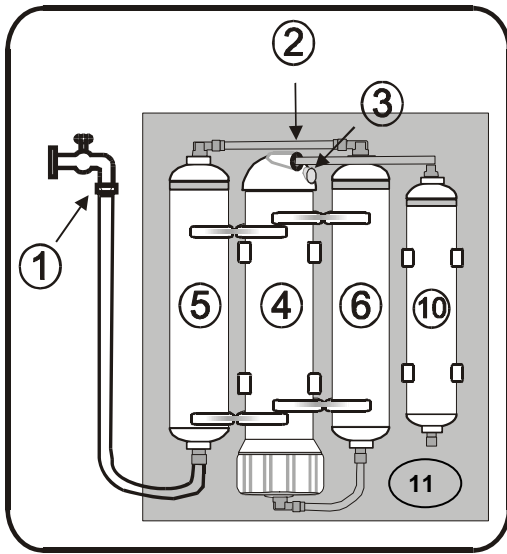

- Connect pressure hose to the tap water (1) and with filter housing (11-3).
- Conduct the included hose (11) for permeate (osmosewater) into the sewerage system.
- Conduct the other included hose (3) for concentrate in a bucket (you can use this water for some species of cichlid fish).
- Open water tap slowly and check whether connections are watertight. Flush RO unit for about 15 minutes with tapwater pressure.
- Hereby a powerful jet of water gets out of the concentrate hose, and a small jet out of the permeate hose.
- After cleaning, the osmose-water can be used.

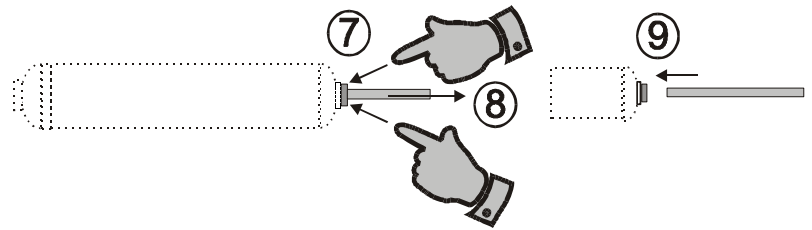

MAINTENANCE

In order to prolong the life of the membrane (4) of the RO unit, sediment INLINE-filter (6) and carbon INLINE-filter (5) have to be replaced 3-12 times per year according to the pollution of the water.

REPLACEMENT OF THE SEDIMENT INLINE-FILTER (6) OR THE CARBON INLINE-FILTER (5) OR THE AQUA PUR JUNIOR CARTRIDGE (10)

To replace the sediment INLINE-filter (6), the carbon INLINE-filter (5) or the AQUA PUR JUNIOR cartridge (10), shut water supply. Wait till no more water is running out of the RO unit. For removing the hose from the INLINE-filter, press the ring (7) and pull of the hose (8). Then replace the new INLINE-filter. For installing the hose in the new INLINE-filter, press the ring (9) and pull of the hose (8). Checkif the connections are watertight.

IMPORTANT

- Flush the RO-unit with tapwater for about 2 minutes each time before using in order to remove deposits from the membrane.
- The hoses musn't be bent or shut (for example by solenoid valve or hose clamp).
- Permeate and concentrate must always flow unhinderedly, otherwise a concentrate or permeate counterpressure arises which causes a cracking of the membrane.
- In case of tapwater pressure over 75 psi and in case of very soft water the capacity can improve by 100%.
- In the same time, in case of tapwater pressure under 65 psi and in case of very hard water the capacity can decrease a lot.
- This RO unit works with a pressure from 3,5 - 4,5 bar, and with a water temperature of minimum 12°C. It retention is around 90-95% +-3% (with 4 bar and 12°C).
- This RO-unit is ready for use.

USE

A RO unit removes the substances content from the tap water. It provides water perfect for the needs of a freshwater or a salt water aquarium.

ELIMINATION OF BREAKDOWNS

Your RO unit is very safe and easy to service, however breakdowns can occur :

RO unit does not produce enough osmose-water !

- Water is too cold (under 12°C)
- Water pressure in the main system is not sufficient / min.45 psi.
- Check pressure hose whether it is blocked or bent.
- Check whether filter(s) is / are dirty.

RO unit rejects less than the tolerance of 90-95%

Water is too cold or too hard, concentration polarisation in the RO modules is too high.

- Check whether filter(s) is / are dirty.

If there is no improvement, call the aftersales service.

WARRANTY CONDITIONS

- The membrane of the RO unit has 6 months warranty in case of material and production faults. This warranty is only valued with purchase and sending of the warranty card. The INLINE-filters (sediment INLINE-filter (6), the carbon INLINE-filter (5) and the AQUA PUR JUNIOR cartridge (10)) are not included in this warranty.
- The warranty covers the value of the purchase price.
- The warranty doesn't cover Incorrect treatment, damages caused through filthy conditions and misconduct. Outside influences do not apply.
- The warranty doesn't apply when the RO unit has been used with a tap water with following chemical-physical characteristics : Maximum temperature of the water : 30°C / PH : 3 to 11 / Strontium & Sarium : in traces / liberated chlor: max 100 ppm/h / Iron (Fe++) <0.1 mg/l / Concentration in manganese <0.05 mg/l / Salt <1500mg/l / Concentration in oxidizing agents <0.1mg/l.

USE OF AQUA PUR JUNIOR

You can improve the quality of the water by using a RO unit. But according to the tap water quality, you can still have residues from nitrates, phosphates and/or silicates.

For exemple : when tap water has a conductivity of 1000 μ /s (micro-siemens) and after treatment by reverse osmose a permeat (osmose water) around 50 μ /s.

Exemple 2 : when tap water has a nitrate (NO_3) content of 50 mg per liter, and after treatment by reverse osmose a permeat (osmose water) with a content of around 7,5 mg /l.

(Those values depend on the quality and the wearing degree of the membrane).

Those small residues of nitrates, phosphates and/or silicates can sometimes start up the development of algae in the aquarium after a while, or cause problems by reproduction. To avoid those problems, **AQUATIC NATURE** in cooperation with chemists has conceived **AQUA PUR JUNIOR (10)**.

By using **AQUA PUR JUNIOR (10)**, all nitrates, phosphates and silicates in the water will be removed. The conductivity (Micro-siemens (μ /s) goes down rapidly to a value around 0,5 μ /s.

PROCEDURE

AQUA PUR JUNIOR (10) must be connected to the RO unit.

The hose for permeat (osmose water) must be connected to the head of **AQUA PUR JUNIOR**. Let the water run during about 10 minutes, in order to the ion exchanger could be prepared. Then the osmose water can be used. Do the same by replacement of a new cartridge **AQUA PUR JUNIOR**.

AQUA PUR JUNIOR must always stay connected to the RO unit to avoid that the content dries up.

Check regularly the activity of **AQUA PUR JUNIOR** with a nitrate-, phosphate- test or a conductivity-meter.

When one value goes up, it means that the capacity of retention of **AQUA PUR** is finished.

Capacity of retention : NO_3 (nitrates) +/- 20 gr
 PO_4 (phosphates) +/- 10 gr
 SiO_2 (silicates) +/- 4 gr

WARNING

The cartridges **AQUA PUR JUNIOR** can't be regenerated.

You can replace the cartridge **AQUA PUR JUNIOR** (Art. N°: **AN AQP 010 36**)

Product **AQUA PUR** in the cartridge (Art. N°: **AQUA PUR** : **AN AQP 010 46**)